



IAQ Map Legend - Winter Operation

- Natural ventilation: Operable windows and/or louvres should be used to manage fresh air, balancing thermal comfort and ventilation.
- Mechanical ventilation: Fresh air is introduced by the heating, ventilation and air conditioning system when in operation. Windows can remain closed and no action is required by the school.
- Minimise use of this space. Ventilation improvements are currently being scoped or implemented.

Note: White spaces are to be used in accordance with COVID-19 requirements and current health advice.

ISSUE	AMENDMENT	DRAWN	VER D	APPO	DATE

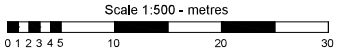

SCALE
1:500
DATE
APRIL 2016
DRAWING SHEET SIZE = A3

PROJECT
CANBERRA HIGH SCHOOL
INFRASTRUCTURE & CAPITAL WORKS
SCHOOL LAYOUT PLAN
GROUND FLOOR

REVISION

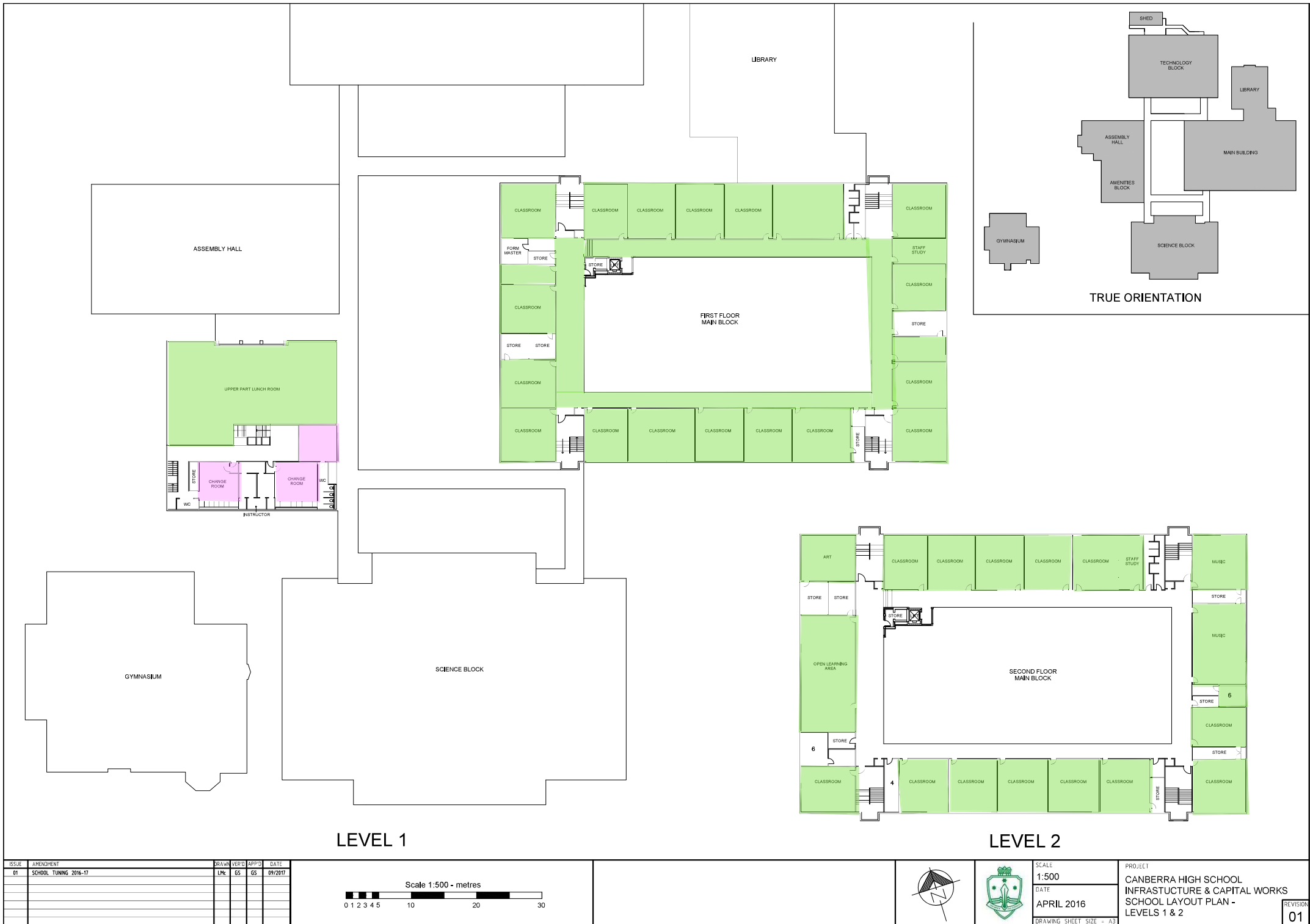

ISSUE	AMENDMENT	DRAWN	VER'D	APP'D	DATE
01	SCHOOL TUNING 2016-17	LME	GS	GS	09/2017

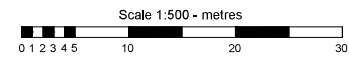

SCALE
1:500
DATE
APRIL 2016
DRAWING SHEET SIZE = A3

PROJECT
CANBERRA HIGH SCHOOL
INFRASTRUCTURE & CAPITAL WORKS
SCHOOL LAYOUT PLAN -
LEVELS 1 & 2